

Pavilion 10

| Halls | Length*Width | Area in m ² | Height m |
|-----------|--------------|------------------------|----------|
| Lobby | 29.57*5.5 | 508 | 3.39 |
| Plenary A | 26.69*38.58 | 1006 | 6.00 |
| Plenary B | 25.43*29.11 | 783 | 6.00 |
| Foyer | 19.65*57.20 | 543 | 2.99 |
| Hall A1 | 14.98*25.33 | 385 | 3.02 |
| Hall A2 | 14.85*14.09 | 211 | 2.96 |
| Hall A3 | 14.85*17.25 | 251 | 2.96 |
| Hall A4 | 12.34*19.25 | 240 | 2.90 |
| Hall A5 | 11.36*19.25 | 216 | 2.90 |

- Lobby
- Foyer
- Central hall
- Conference halls
- Dining
- Toilets
- Firefighting station

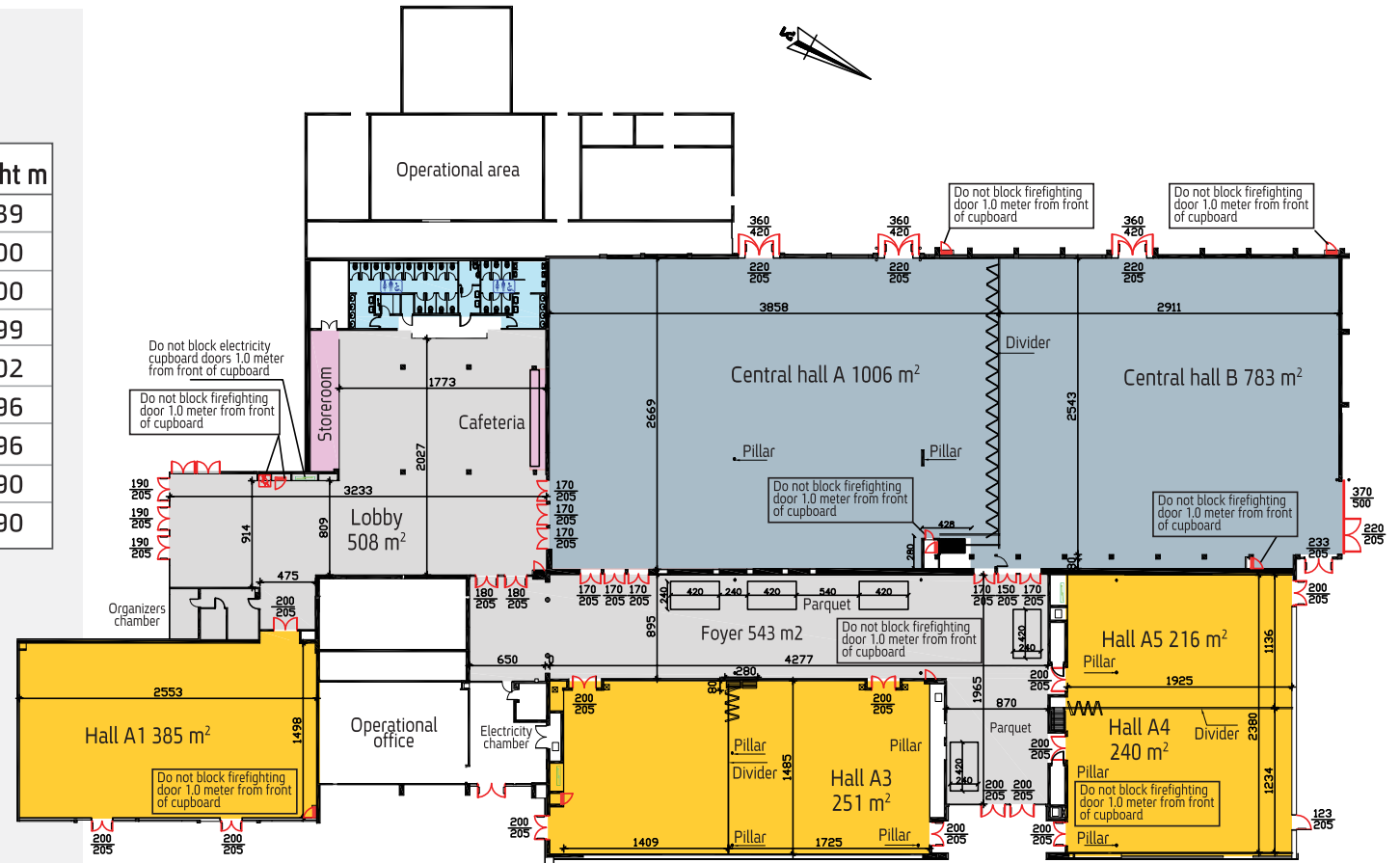

The dimensions shown in this diagram do not constitute an alternative to actual measurement of the grounds that are at the responsibility of the organizer.